

**506 Queensberry Street North Melbourne VIC**

**2**

- > SHOP & DWELLING
- > TWO GENUINE STREET FRONTAGES
- > OFFERED WITH A SHORT TERM LEASE

Vision Real Estate is delighted to offer this magnificent two-level Victorian residence and shop, ideally positioned close to the intersection of Errol St and Queensberry St in the ever so popular city fringe suburb of North Melbourne.

Expressions of Interest Closing on the 20th August at 12pm

Key Features:

\*Total land area - 195 sqm\*

[For full version visit the website](https://www.visionrealestate.com.au)

<b>Type</b>	: Retail
<b>Price</b>	: Contact Frank Romeo
<b>Building Size</b>	: 165 sqm
<b>Land Size</b>	: 195 sqm
<b>View</b>	: <a href="https://www.visionrealestate.com.au/sale/vic/inner-city/north-melbourne/commercial/retail/7751600">https://www.visionrealestate.com.au/sale/vic/inner-city/north-melbourne/commercial/retail/7751600</a>



**Frank Romeo**  
03 9654 8888

# 506 Queensberry St, North Melbourne

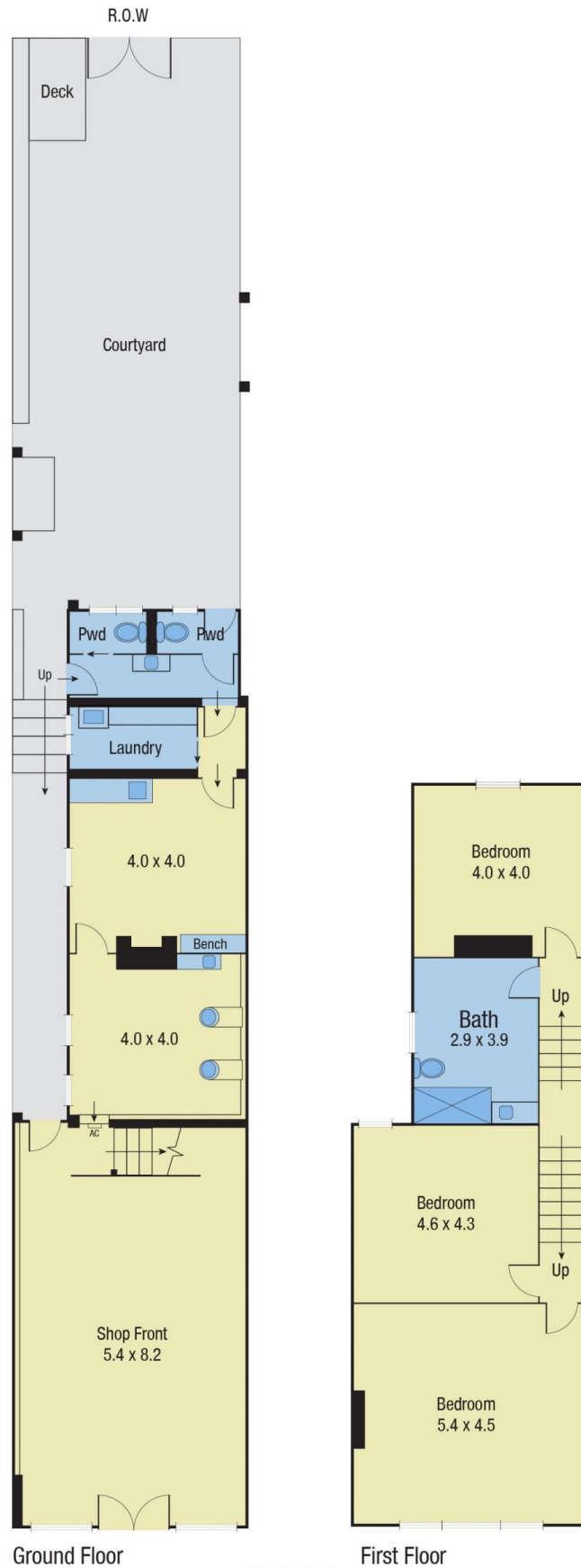

Disclaimer: Every precaution has been taken to verify the accuracy of the above details.  
However, prospective purchasers are advised to make their own enquiries.  
We do not accept responsibility for any errors or omissions.